

PRODUCT SPOTLIGHT

ATRO INTRAAX/VANTRAAX BUSHING

ATRO offers solutions for OE #S-24691, S-26321 and A6914.

DIRECT REPLACEMENT BUSHINGS

- Traditional tri-functional design
- Voids like the standard rubber bushing.
- Similar OD (5 7/8") to the rubber bushing (6") and like rubber is compressed into the beam hole which is 5 1/2" ID.
- ATRO offers installation tool #PT50-59307 to install this bushing
- The inner sleeve is bonded in place

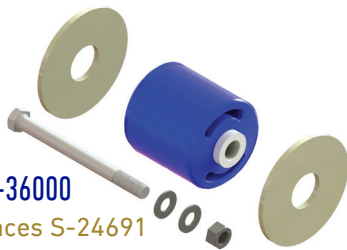

PB50-36000
 Replaces S-24691
 Kit includes Hex Bolt
 Must torque to 500-550 ft-lbs.



PB50-36001
 Replaces S-24691
 Kit includes Shear Bolt
 Shear bolt head snaps off at the proper torque.

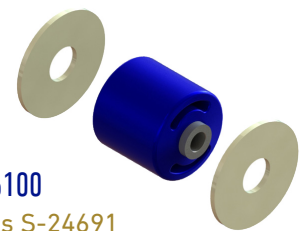

PB50-36100
 Replaces S-24691
 Kit does not include Bolt
 Wear washers included.

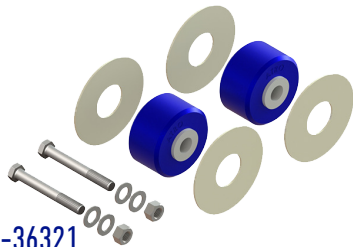

PB50-36321
 Replaces S-26321
 Kit includes Hex Bolt
 Must torque to 500-550 ft-lbs.

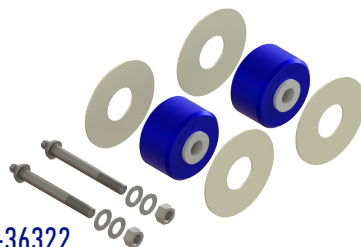

PB50-36322
 Replaces S-26321
 Kit includes Shear Bolt
 Shear bolt head snaps off at the proper torque.

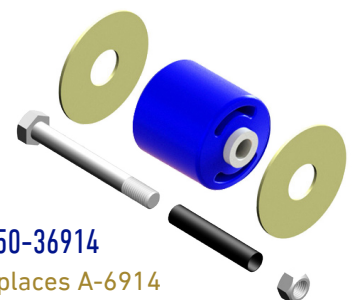

PB50-36914
 Replaces A-6914
 Kit includes Hex Bolt & Bolt Sleeve
 Must torque to 775-825 ft-lbs.

ATRO P/N	OE bushing	Voids	Inner pin rotation	Bolt type	Hardware included	Alignment	Install tool	Qty/axle
PB50-36000	S-24691	Yes	No	Hex head	Yes	Quick-Align	PT50-59307	2
PB50-36001	S-24691	Yes	No	Shear Bolt	Yes	Quick-Align	PT50-59307	2
PB50-36100	S-24691	Yes	No	n/a	Wear washers only	Quick-Align	PT50-59307	2
PB50-36321	S-26321	Yes	No	Hex head	Yes	Quick-Align	PT50-59376	1
PB50-36322	S-26321	Yes	No	Shear Bolt	Yes	Quick-Align	PT50-59376	1
PB50-36914	A-6914	Yes	No	Hex head	Yes	Welded Alignment	PT50-59307	2

Contact ATRO customer service with questions or for more information about the full line of ATRO parts at 1.800.325.6114.

PRODUCT SPOTLIGHT

ATRO PARTS
ENGINEERED | DURABLE | RELIABLE
MANUFACTURED IN ST. CLAIR, MISSOURI | U.S.A.

ATRO INTRAAX/VANTRAAX BUSHING

WEAR ITEMS:

Tri-functional bushing

- Mode of failure: bushing tube spacers melt, inner sleeve separated from rubber.
- Cause: excessive vertical movement of suspension arm caused buildup of excessive heat
- Note: check to see if tires are out of balance or if shocks have failed.

TECH TIP:

ATRO's installation tools will install/remove OE bushings and/or ATRO bushings. Remove the alignment pins when installing/removing the ATRO "Easy Install" bushings which don't have voids. Conversely, the OE tool can be used to install/remove both OE and ATRO; simply remove alignment pins from the rear drive plate before attempting ATRO "Easy Install" installation/removal.

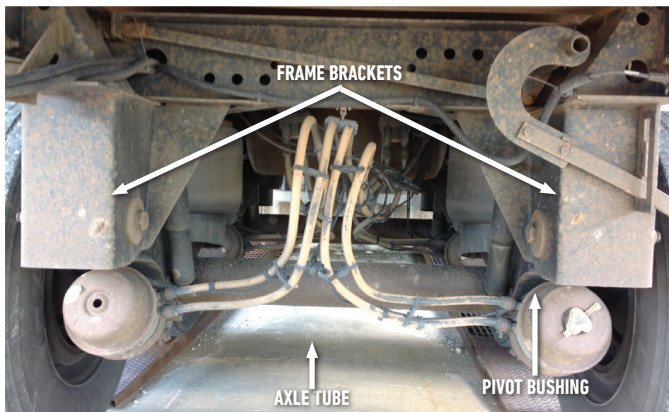

INSTALLATION TOOL: PT50-59307

Do not use an impact wrench on this tool. Must lubricate before use. Can be used to install/remove ATRO & rubber pivot bushing.

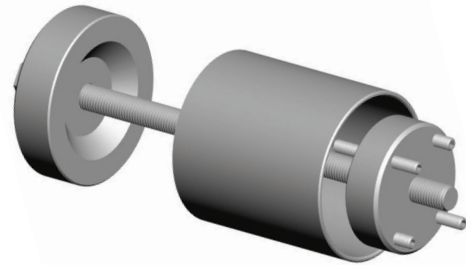

KEY ATRO ADVANTAGES

1 Impervious to chemical attack

- Oil & Grease
- Calcium Chloride (Winter Salt Melt)
- Citric Acid & Acid Based Cleaners
- Ethylene Glycol
- Gas, Kerosene & Diesel Oil
- Many More

2 ATRO's polyurethane is 2-5x stronger than rubber

- ATRO Polys are specifically engineered to the function of the part providing added durability and reliability to the suspension.
- ATRO Polys maintains at least 2x or greater tensile and tear strength and 2x the elongation vs. rubber.

3 11 Proprietary Formulas

- ATRO determines which of ATRO's 11 proprietary polyurethane formulas best suit the part upon evaluation of its application, purpose and function.
- As a result, ATRO Intraax bushings last longer and are backed up by a three year warranty.

CELEBRATING 30 YEARS
ATRO
POLYURETHANE • SOLUTIONS

POLYURETHANE PARTS | SOLUTIONS FOR HEAVY TRUCKS

ATROBUSHING.COM
©2018 ATRO ENGINEERED SYSTEMS, INC.

6 Bolte Lane
St. Clair, Missouri 63077 | U.S.A.
(800) 325.6114 | Fax (866) 920.2005