

TECHNICAL GUIDELINE

ATRO PARTS
ENGINEERED | DURABLE | RELIABLE
MANUFACTURED IN ST. CLAIR, MISSOURI | U.S.A.

AIR LEAF BUSHING KIT

PB75-29101 PETERBILT LOW MOUNT AIR LEAF & PB75-29674 PETERBILT AIR LEAF

1. Insert the inner polyurethane sleeves into each end of the eye casting. Insert the steel spacer tube and seat the bushings as far into the casting as is possible before the spacer tube tightens up. Remove the spacer tube.

NOTE: Please be aware that the inner polyurethane sleeves in our kits are tapered and must be inserted into the eye casting small end first. (The OE rubber parts are straight sided and can be installed from either end.)

2. Insert the eye casting into the hanger and align the eye casting eye with hanger's eye. (This may be a tight fit.)

3. Insert the spacer tube through the hanger eye and into the inner polyurethane bushings.

4. Install the hard polyurethane washers into both ends of the hanger (stepped side inwards). You may have to tap them down to seat them.

5. Insert a compression washer on both ends with counter-bored side facing outwards.

6. Run bolt through entire assembly from the outboard side. (If end of bolt does not protrude sufficiently to start nut either reseal the hard polyurethane washers or use a longer bolt and nut to reseal the whole assembly.)

7. Install nut and torque to manufacturer's specification. (Do not reuse old bolts.)

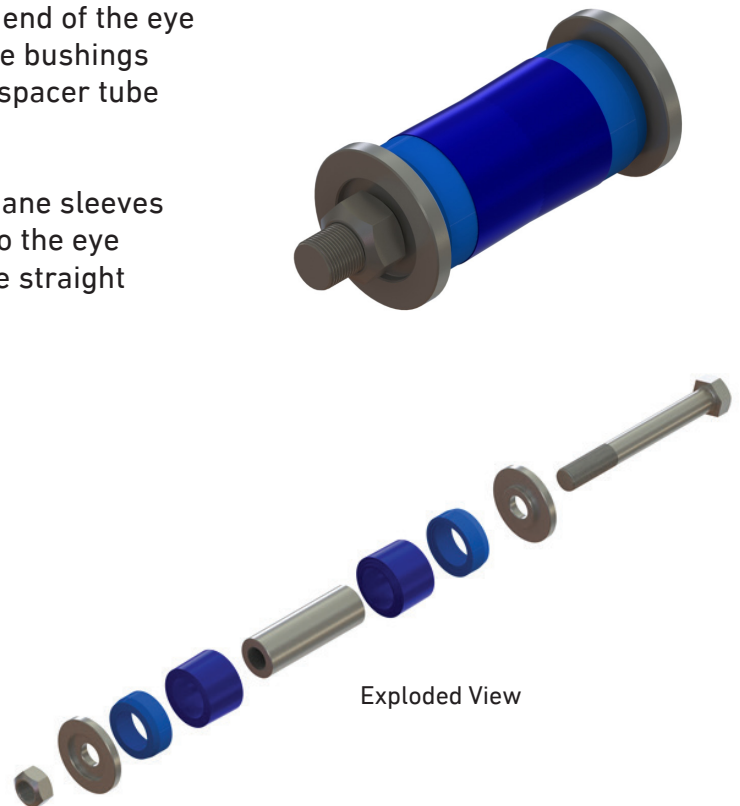

Contact ATRO customer service with questions or for more information about the full line of ATRO parts at 1.800.325.6114.

SUSPENSION SCHEMATICS

ATRO PARTS

ENGINEERED | DURABLE | RELIABLE
MANUFACTURED IN ST. CLAIR, MISSOURI | U.S.A.

AIR LEAF BUSHING KIT

PB75-29101 PETERBILT LOW MOUNT AIR LEAF & PB75-29674 PETERBILT AIR LEAF

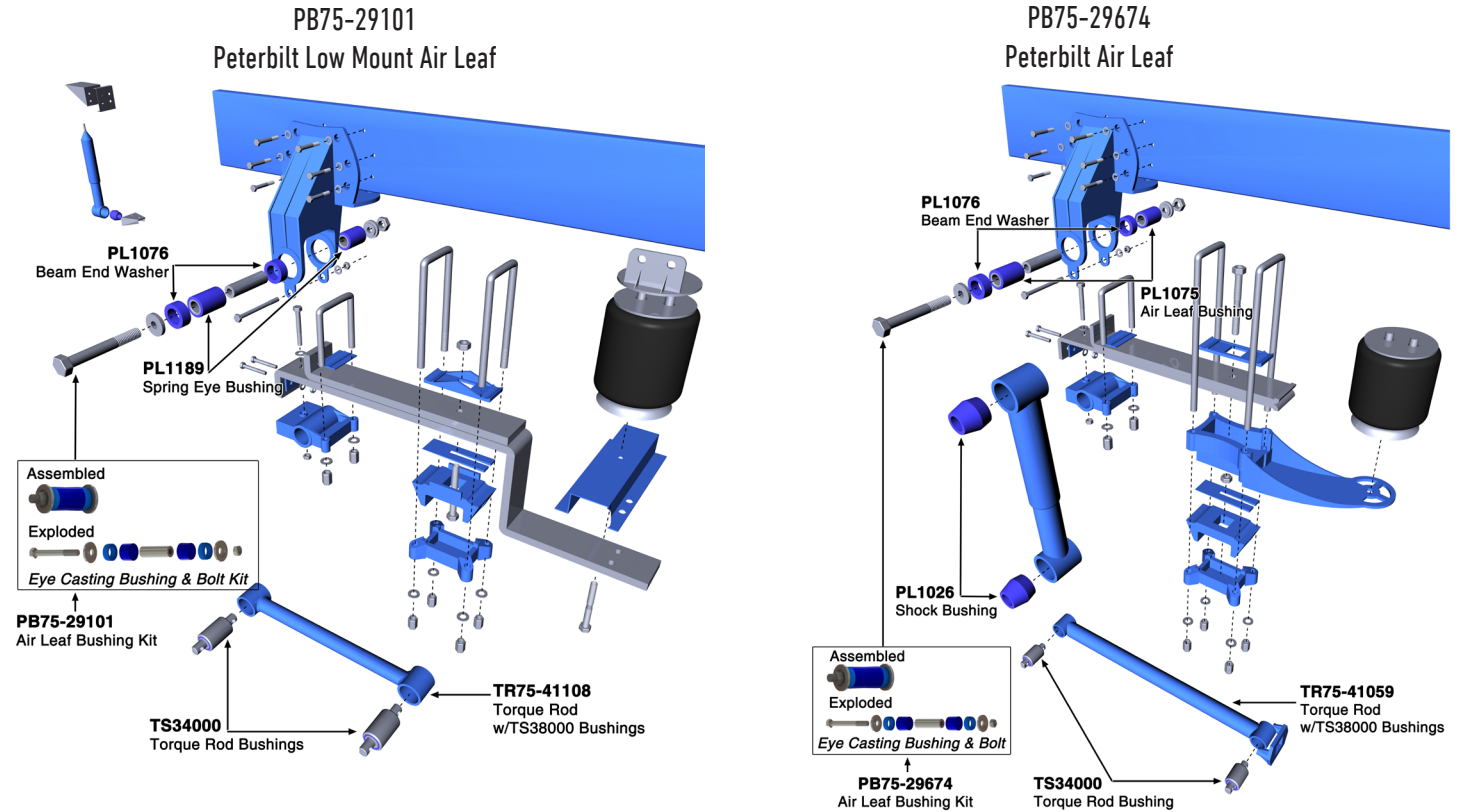

This air suspension has with a maximum capacity rating of 40,000 pounds. Like the Air Leaf, it does not have lower radius rods like those found on the Air Trac and tends to have a smoother ride than both the Air Leaf and Air Trac. The air bags are supported on the Z-spring assembly; no paddle.

A pivot bushing (ATRO's PB75-29101, OE# 03AL2) is housed in an eye casting that is bolted to the spring.

- PB75-29101 is a spring eye bushing service kit that has bushings, sleeve, washers and hardware. The polyurethane components within this kit are PL1076 and PL1189 (2 per kit) and are also available separately.

This air suspension has a maximum capacity rating of 40,000 pounds. This suspension, like the Low Mount Air Leaf, does not have lower radius rods like those found on the Air Trac. The air bags are supported on a paddle.

The eye casting that is bolted on the spring houses the pivot bushing (ATRO's PB75-29674; OE#03-04059)

- PB75-29674 is a spring eye bushing service kit that has bushings, sleeve, washers and hardware. The polyurethane components within this kit are PL1076 and PL1075 (2 per kit) and are also available separately. (PB75-29674 is ½" longer than the original design Low Mount Air Leaf version, PB75-29101.)

CELEBRATING 30 YEARS
ATRO
POLYURETHANE • SOLUTIONS

POLYURETHANE PARTS | SOLUTIONS FOR HEAVY TRUCKS

ATROBUSHING.COM
©2017 ATRO ENGINEERED SYSTEMS, INC.

6 Bolte Lane
St. Clair, Missouri 63077 | U.S.A.
(800) 325.6114 | Fax (866) 920.2005